



Lam-e



St-Pierre

Crosby®

RIGGING ACCESSORIES



EYE BOLT SL-150 SLIDE-LOC

SPECIFICATIONS

- Available in capacities from .5 to 3.2 metric tons.
- Bail is Forged Alloy Steel – Quenched and Tempered.
- Bail swivels 360° degrees.
- Rated at 100% for 90 degree angle.
- Fatigue rated to 20,000 cycles at 1-1/2 times the Working Load Limit.
- Replaceable bolts available, including longer bolts.
- Features QUIC-CHECK® markings on bail to assist in knowing when device is ready for lifting.

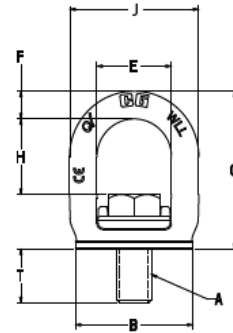

SL-150 UNC SLIDE-LOC™

STOCK NO.	WORKING LOAD LIMIT (T.)	WEIGHT (LBS)	DIMENSIONS (IN.)							EFFECTIVE THREAD
			BOLT SIZE A	B	C	E	F	H	J	
1068407	0.50	0.30	3/8 - 16 X 1	1.40	2.09	1.10	0.33	1.11	1.77	0.60
1068416	0.75	0.53	1/2 - 13 X 1 - 1/4	1.67	2.47	1.30	0.41	1.30	2.13	0.79
1068425	1.50	1.10	5/8 - 11 X 1 - 5/8	2.17	2.98	1.46	0.52	1.46	2.50	1.01
1068434	2.30	2.05	3/4 - 10 X 2	2.71	3.59	1.72	0.63	1.72	2.98	1.26
1068443	2.30	2.16	7/8 - 9 X 2	2.71	3.61	1.72	0.63	1.72	2.98	1.23
1068452	3.20	3.73	1 - 8 X 2 - 1/2	3.25	4.33	2.08	0.76	1.93	3.59	1.59

Safety Factor 4:1

SL-150 METRIC SLIDE-LOC™

STOCK NO.	WORKING LOAD LIMIT (T.)	WEIGHT (KG)	DIMENSIONS (MM.)							EFFECTIVE THREAD
			BOLT SIZE A	B	C	E	F	H	J	
1068515	0.50	0.14	M10 X 1.5 X 25	35.5	53.0	28.0	8.5	27.8	45.0	14.6
1068524	0.75	0.23	M12 X 1.75 X 30	42.5	62.6	33.0	10.5	32.9	54.0	18.3
1068533	1.50	0.50	M16 X 2 X 40	55.0	75.7	37.0	13.2	37.0	63.4	24.5
1068542	2.30	0.94	M20 X 2.5 X 50	68.8	91.1	43.9	16.0	43.6	75.6	31.0
1068551	3.20	1.60	M24 X 3 X 60	82.5	110.0	52.8	19.2	52.8	91.2	37.0

Safety Factor 4:1



Lam-e

LEVAGE
QUÉBEC
LIFTING

St-Pierre



Montréal
Québec
Chicoutimi

| T 514 354-4219 / 1 800 361-4019
| T 418 652-9759 / 1 800 652-9759
| T 418 696-9759 / 1 866 696-9759

www.lamestierre.com