



# Lam-e



# St-Pierre

## Crosby® BOLT TYPE SHACKLES G2130



### FEATURES

- Capacities 1/3 thru 150 metric tons, grade 6
- Working Load Limit and grade "6" permanently shown on every shackle
- Forged – Quenched and Tempered, with alloy bolts
- Hot Dip galvanized or self colored. (85, 120, and 150 metric ton shackles are all hot dip galvanized bows and the bolts are Dimetcoated® and painted red)
- Fatigue rated (1/3t - 55t)
- Shackles 25t and larger are RFID EQUIPPED
- Meets or exceeds all requirements of ASME B30.26
- 6/1 Safety factor

*Bolt Type Anchor shackles with thin head bolt - nut with cotter pin. Meets the performance requirements of Federal Specification RR-C-271F Type IVA, Grade A, Class 3, except for those provisions required of the contractor.*

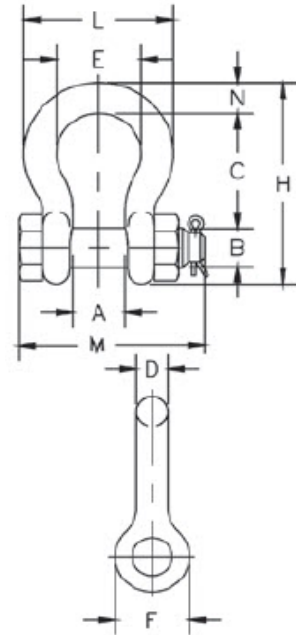

Load Rated

Fatigue Rated



MAXTOUGH



NOMINAL SIZE (IN.)	WLL (T.M.)	STOCK NO.	UPC NO.	WEIGHT (LBS.)	DIMENSIONS (PO.)										TOLERANCE (+/-)	
					A	B	C	D	E	F	H	L	M	N	C	A
3/16	1/3	G21303/16CS-5P	1019464	0.06	0.38	0.25	0.88	0.19	0.60	0.56	1.47	0.98	1.29	0.19	0.06	0.06
1/4	1/2	G21301/4CS-5P	1019466	0.11	0.47	0.31	1.13	0.25	0.78	0.61	1.84	1.28	1.56	0.25	0.06	0.06
5/16	3/4	G21305/16CS-5P	1019468	0.22	0.53	0.38	1.22	0.31	0.84	0.75	2.09	1.47	1.82	0.31	0.06	0.06
3/8	1	G21303/8CS-5P	1019470	0.33	0.66	0.44	1.44	0.38	1.03	0.91	2.49	1.78	2.17	0.38	0.13	0.06
7/16	1-1/2	G21307/16CS-5P	1019471	0.49	0.75	0.50	1.69	0.44	1.16	1.06	2.91	2.03	2.51	0.44	0.13	0.06
1/2	2	G21301/2CS-5P	1019472	0.79	0.81	0.64	1.88	0.50	1.31	1.19	3.28	2.31	2.80	0.50	0.13	0.06
5/8	3-1/4	G21305/8CS-5P	1019490	1.68	1.06	0.77	2.38	0.63	1.69	1.50	4.19	2.94	3.58	0.69	0.13	0.06
3/4	4-3/4	G21303/4CS-5P	1019515	2.72	1.25	0.89	2.81	0.75	2.00	1.81	4.97	3.50	4.15	0.81	0.25	0.06
7/8	6-1/2	G21307/8CS-5P	1019533	3.95	1.44	1.02	3.31	0.88	2.28	2.09	5.83	4.03	4.82	0.97	0.25	0.06
1	8-1/2	G21301CS-5P	1019551	5.66	1.69	1.15	3.75	1.00	2.69	2.38	6.56	4.69	5.39	1.06	0.25	0.06
1-1/8	9-1/2	G213011/8CS-5P	1019579	8.27	1.81	1.25	4.25	1.13	2.91	2.69	7.47	5.16	5.90	1.25	0.25	0.06
1-1/4	12	G213011/4CS-5P	1019597	11.71	2.03	1.40	4.69	1.29	3.25	3.00	8.25	5.75	6.69	1.38	0.25	0.06
1-3/8	13-1/2	G213013/8CS-5P	1019613	15.83	2.25	1.53	5.25	1.42	3.63	3.31	9.16	6.38	7.21	1.50	0.25	0.13
1-1/2	17	G213011/2CS-5P	1019631	19.00	2.38	1.66	5.75	1.53	3.88	3.63	10.00	6.88	7.73	1.62	0.25	0.13
1-3/4	25	G213013/4CS-5P	1019659	33.91	2.88	2.04	7.00	1.84	5.00	4.19	12.34	8.80	9.68	2.25	0.25	0.13
2	35	G21302CS-5P	1019677	52.25	3.25	2.30	7.75	2.08	5.75	4.81	13.68	10.15	10.81	2.40	0.25	0.13
2-1/2	55	G213021/2CS-5P	1019695	98.25	4.13	2.80	10.50	2.71	7.25	5.69	17.90	12.75	13.58	3.13	0.25	0.25
3	85	G21303CS-5P	1019711	154.00	5.00	3.30	13.00	3.12	7.88	6.50	21.50	14.62	15.13	3.62	0.25	0.25
3-1/2	120	G213031/2CS-5P	1019739	265.00	5.25	3.76	14.63	3.62	9.00	8.00	24.88	17.02	17.00	4.38	0.25	0.25
4	150	G21304CS-5P	1019757	338.00	5.50	4.26	14.50	4.00	10.00	9.00	25.68	18.00	17.75	4.56	0.25	0.25

**NOTE: Maximum Proof Load is 2.0 times the Working Load Limit. Minimum Ultimate Strength is 6 times the Working Load Limit.**



# Lam-e



# St-Pierre



Montréal  
 Québec  
 Chicoutimi

| T 514 354-4219 / 1 800 361-4019  
 | T 418 652-9759 / 1 800 652-9759  
 | T 418 696-9759 / 1 866 696-9759

www.lamestierre.com