



# Lam-e



# St-Pierre

## Crosby® SCREW PIN SHACKLES

### FEATURES



- Capacities 1/3 thru 55 metric tons, grade 6
- Forged - Quenched and Tempered, with alloy pins
- Working Load Limit and grade "6" permanently shown on every shackle
- Hot Dip galvanized or self colored / Fatigue rated
- Shackles 25t and larger are RFID EQUIPPED
- 6/1 Safety factor

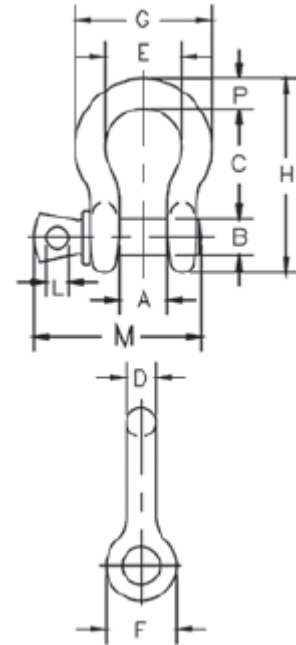

*G-209 Screw pin anchor shackles meet the performance requirements of Federal Specification RR-C-271F Type IVA, Grade A, Class 2, except for those provisions required of the contractor.*

Load Rated

Fatigue Rated



MAXTOUGH



NOMINAL SIZE (IN.)	WLL (T.M.)	STOCK NO.	UPC NO.	WEIGHT (LBS.)	DIMENSIONS (IN.)											TOLERANCE (+/-)	
					A	B	C	D	E	F	G	H	L	M	P	C	A
3/16	1/3	G2093/16CS-5P	1018357	0.06	0.38	0.25	0.88	0.60	0.56	0.56	0.98	1.47	0.16	1.14	0.19	0.06	0.06
1/4	1/2	G2091/4CS-5P	1018375	0.10	0.47	0.31	1.13	0.25	0.78	0.61	1.28	1.84	0.19	1.43	0.25	0.06	0.06
5/16	3/4	G2095/16CS-5P	1018393	0.18	0.53	0.38	1.22	0.31	0.84	0.75	1.47	2.09	0.22	1.71	0.31	0.06	0.06
3/8	1	G2093/8CS-5P	1018419	0.31	0.66	0.44	1.44	0.38	1.03	0.91	1.78	2.49	0.25	2.02	0.38	0.13	0.06
7/16	1-1/2	G2097/16CS-5P	1018437	0.38	0.75	0.50	1.69	0.44	1.16	1.06	2.03	2.91	0.31	2.37	0.44	0.13	0.06
1/2	2	G2091/2CS-5P	1018455	0.72	0.81	0.63	1.88	0.50	1.31	1.19	2.31	3.28	0.38	2.69	0.50	0.13	0.06
5/8	3-1/4	G2095/8CS-5P	1018473	1.37	1.06	0.75	2.38	0.63	1.69	1.50	2.94	4.19	0.44	3.34	0.69	0.13	0.06
3/4	4-3/4	G2093/4CS-5P	1018491	2.35	1.25	0.88	2.81	0.75	2.00	1.81	3.50	4.97	0.50	3.97	0.81	0.25	0.06
7/8	6-1/2	G2097/8CS-5P	1018516	3.62	1.44	1.00	3.31	0.88	2.28	2.09	4.03	5.83	0.50	4.50	0.97	0.25	0.06
1	8-1/2	G2091CS-5P	1018534	5.03	1.69	1.13	3.75	1.00	2.69	2.38	4.69	6.56	0.56	5.13	1.06	0.25	0.06
1-1/8	9-1/2	G20911/8CS-5P	1018552	7.41	1.81	1.25	4.25	1.16	2.91	2.69	5.16	7.47	0.63	5.71	1.25	0.25	0.06
1-1/4	12	G20911/4CS-5P	1018570	9.50	2.03	1.38	4.69	1.29	3.25	3.00	5.75	8.25	0.69	6.25	1.38	0.25	0.06
1-3/8	13-1/2	G20913/8CS-5P	1018598	13.53	2.25	1.50	5.25	1.42	3.63	3.31	6.38	9.16	0.75	6.83	1.50	0.25	0.13
1-1/2	17	G20911/2CS-5P	1018614	17.20	2.38	1.63	5.75	1.54	3.88	3.63	6.88	10.00	0.81	7.33	1.62	0.25	0.13
1-3/4	25	G20913/4CS-5P	1018632	27.78	2.88	2.00	7.00	1.84	5.00	4.19	8.86	12.34	1.00	9.06	2.25	0.25	0.13
2	35	G2092CS-5P	1018650	45.00	3.25	2.25	7.75	2.08	5.75	4.81	9.97	13.68	1.22	10.35	2.40	0.25	0.13
2-1/2	55	G20921/2CS-5P	1018678	85.75	4.13	2.75	10.50	2.71	7.25	5.69	12.87	17.84	1.38	13.00	3.13	0.25	0.25

**NOTE: Maximum Proof Load is 2.0 times the Working Load Limit. Minimum Ultimate Strength is 6 times the Working Load Limit.**



# Lam-e



# St-Pierre



Montréal  
 Québec  
 Chicoutimi

T 514 354-4219 / 1 800 361-4019  
 T 418 652-9759 / 1 800 652-9759  
 T 418 696-9759 / 1 866 696-9759

www.lamestierre.com