



Beam Clamp - IPTK [FR]

Informations du produit



This IPTK series beam clamp is suitable for use as a temporary tackle eye for horizontal lifting and transportation of steel (H) beams, profiles and structures. Can also be used as upside down attached (temporary) lifting point.

Features:

- Available in capacities of 2 through 25 metric tons.
- Wide variety of jaw openings available: 75 to 1020 mm.
- Welded alloy steel body for strength and smaller size. Forged alloy components, where required.
- Individually Proof Tested to 2 times the Working Load Limit with certification.
- User manual with test certificate is included with each clamp.
- Maintenance and repair kits are available.
- All sizes are RFID EQUIPPED.

... [En savoir plus](#)

Matériau: Steel

Marquage: Selon la norme, Marqué CE, WLL, Logo, Jaw opening, Serial number

Plage de température d'utilisation: -40°C up to +100°C

Norme: EN 13155



Beam Clamp - IPTK [FR]

Dessin technique

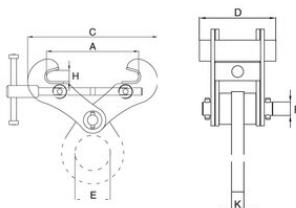

Données techniques

Réf.	CMU tonne(s)	Ouverture in	Modèle	A in	C mm	D in	E in	H in	K in	Poids lb
16.022700996	2	2.95-7.48	2-IPTK	2.95-7.48	A+80	4,92	2,95	0,98	0,79	13,23
16.022700997	3	2.95-7.48	3-IPTK	2.95-7.48	A+80	4,92	2,95	0,98	0,79	14,33
16.022700998	4	5.91-11.02	4-IPTK	5.91-11.02	A+100	4,92	2,95	1,38	0,79	18,74
16.022700994	5	4.72-13.78	5-IPTK	4.72-13.78	A+195	4,92	2,95	1,57	0,79	24,25