



Wedge Socket Crosby S-421T

Product information



Features:

- Secures the tail or “dead end” of the wire rope to the wedge, thus eliminates loss or “Punch out” of the wedge.
- Eliminates the need for an extra piece of rope, and is easily installed.
- The TERMINATOR™ wedge eliminates the potential breaking off of the tail due to fatigue.
- The tail, which is secured by the base of the clip and the wedge, is left undeformed and available for reuse.
- Incorporates Crosby’s patented QUIC-CHECK™ “Go” and “No-Go” feature cast into the wedge.
- Utilises standard Crosby Red-U-Bolt wire rope clip.
- Generates a minimum efficiency of 80% based on the catalogue breaking strength of the wire rope.
- Pin diameter and jaw opening allows wedge and socket to be used in conjunction with open swage and spelter sockets.

Wedge sockets meet the performance requirements of Federal Specification RR-S-550F, Type C, except those provisions required of the contractor.

... [Read more](#)

Material: Cast Steel.

Marking: According to standard, ID code and Manufacturer's symbol.

Finish: Painted.

Standard: EN 13411-6

Safety factor: 5:1



Wedge Socket Crosby S-421T

Blueprint

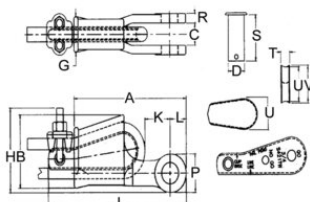

Technical data

Part code	Rope Ø range mm	Finish	A in	B in	C +/- 2.29 mm in	D, in	G, in	H, in	J* mm in	K* mm in	L in	Pmm in	Rmm in	S in	T in	U mm in	V mm in	Weight lb
10.201035000	9-10	Painted	5.71	2.72	0.79	0.79	1.38	3.03	7.8	1.85	0.87	1.54	0.43	2.13	0.43	1.22	1.38	3.17
10.201035009	11-13	Painted	6.89	3.46	0.98	0.98	1.61	3.74	8.9	1.26	1.02	1.93	0.47	2.56	0.51	1.73	1.85	6.15
10.201035018	14-16	Painted	8.27	4.29	1.22	1.18	2.09	4.49	10.75	1.97	1.22	2.24	0.55	3.23	0.67	2.01	2.17	9.7
10.201035027	18-19	Painted	9.88	5.12	1.5	1.38	2.44	5.28	12.36	2.4	1.38	2.6	0.63	3.62	0.75	2.32	2.56	14.51
10.201035036	20-22	Painted	11.26	5.87	1.73	1.61	2.68	6.14	14.37	2.48	1.65	3.11	0.75	4.29	0.87	2.68	2.91	21.5
10.201035045	24-26	Painted	12.8	6.34	2.01	2.01	2.91	6.97	16.3	3.03	2.01	3.74	0.87	4.69	1.02	2.87	3.27	30.64
10.201035054	28	Painted	14.37	6.93	2.24	2.24	3.31	7.64	18.35	2.56	2.24	4.25	0.98	5.43	1.06	3.23	3.54	45.19
10.201035063	30-32	Painted	16.34	8.74	2.6	2.48	3.54	9.41	20.47	2.91	2.32	4.49	1.02	6.14	1.18	4.61	4.92	64.82