

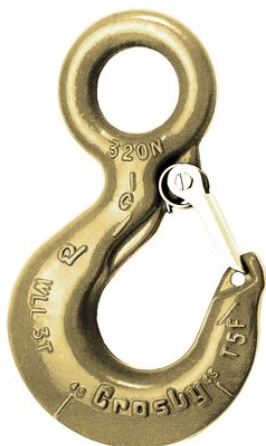

Eye Hook Crosby L-320AN

Product information



Features:

- Proper design, careful forging and precision controlled quenched and tempering give maximum strength without excessive weight and bulk.
- Hook extra marked with Deformation Indicators – Two strategically placed marks, one below just the shank or eye and the other on the hook tip, which allows for a QUIC-CHECK™ measurement to determine if the throat opening has changed, thus indicating abuse or overload. To check, use a measuring device to measure the distance between the marks. If the measurement does not meet the dimensions shown below (Deformation Indicator AA), the hook should be inspected further for possible damage.
- Hook extra marked with Angle Indicators – Indicates the maximum included angle which is allowed between two (2) sling legs in the hook.
- Also Available in Carbon steel Grade 4.

... [Read more](#)

Material: Alloy steel

Marking: According to standard, CE-marked

Standard: EN 1677-2

Warning: From WLL 31.5 tons up to 60 tons safety factor = 4.5:1

Safety factor: 5:1

Grade: 8



Eye Hook Crosby L-320AN

Blueprint

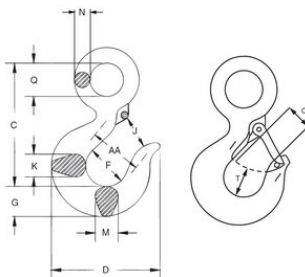

Technical data

Part code	WLL (metric) tonnes	Weight lb
11.101022380	1.25	0.62
11.101022391	1.6	0.88
11.101022402	2.5	1.43
11.101022413	3.2	2.07
11.101022424	5.4	4.3
11.101022435	8	8.29
11.101022446	11.5	14.99
11.101022457	16	20.77
11.101022468	22	39.46
11.101022477	31.5	59.97
11.101023565	37	104.94
11.101023583	45	147.71
11.101023609	60	227.08