



## Swivel Eye / Jaw Crosby S4

### Product information



**Design:** Swivel with eye and jaw equipped with tapered roller thrust bearing.

**Features:**

- Suitable for frequent rotation under load.
- All swivels individually Proof Tested to 2 times the Working Load Limit.
- Pressure lube fitting provided.
- All jaws complete with bolts, nuts and cotter pins.
- Other types and capacities up to 1250 t available on demand.

... [Read more](#)

**Marking:** CE-marked

**Note:** Always check before use if your steel wire rope is suitable for use with a swivel.

**Warning:** Not to be used on demolition- (wrecking-) balls!

**Safety factor:** 5:1



## Swivel Eye / Jaw Crosby S4

### Blueprint

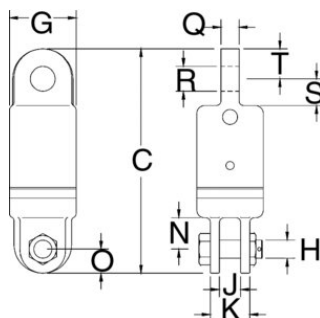

### Technical data

Part code	Rope Ø range mm	WLL (metric) tonnes	Swivel No	C in	G, in	H, in	J in	K in	Nmm in	Omm in	Qmm in	Rmm in	S in	T in	Weight lb
11.46297048	13	3	3-S-4	9.33	2.76	0.75	0.88	1.62	1.31	1	0.75	1.03	1.12	1.25	8.99
11.46297244	16	5	5-S-4	10.08	2.99	0.88	1	2.24	1.62	1.12	1	1.28	1.25	1.25	12.35
11.46297440	19	8.5	8-S-4	12.24	4.02	1	1.56	2.81	2.13	1.38	1.25	1.41	1.62	1.5	29.1
11.46297645	22	10	10-S-4	16.1	4.49	1.5	1.75	3.39	3.5	1.75	1.69	1.69	2.76	1.88	44.09
11.46297841	26	15	15-S-4	16.73	5	1.5	1.75	3.39	3.5	1.75	1.94	2.03	2.76	2.13	61.07
11.46298145		25	25-S-4	21.5	5.98	2.01	2.01	4.61	3.68	2.38	2.24	2.3	3.88	2.38	134.48
-		35	35-S-4	21.5	6.5	2.01	2.01	4.61	3.68	2.38	2.24	2.3	3.88	2.38	149.91
11.46298341		45	45-S-4	25.87	7.01	2.24	2.5	5	4.02	2.99	2.5	2.54	4.02	2.99	224.87