



Swivel Jaw / Jaw Crosby S2

Product information



Design: Swivel with jaws equipped with tapered roller thrust bearing.

Features:

- Suitable for frequent rotation under load.
- All swivels individually Proof Tested to 2 times the Working Load Limit.
- Pressure lube fitting provided
- All jaws complete with bolts, nuts and cotter pins.
- Other types and capacities up to 1250 t available on demand.

... [Read more](#)

Marking: CE-marked

Note: Always check before use if your steel wire rope is suitable for use with a swivel.

Warning: Not to be used on demolition- (wrecking-) balls!

Safety factor: 5:1



Swivel Jaw / Jaw Crosby S2

Blueprint

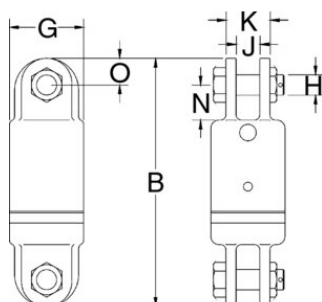

Technical data

Part code	Rope Ø range mm	WLL (metric) tonnes	Swivel No	B in	G, in	H, in	J in	K in	Nmm in	Omm in	Weight lb
11.46297020	13	3	3-S-2	9.29	2.76	0.75	0.88	1.62	1.31	1	9.63
11.46297226	16	5	5-S-2	10.31	2.99	0.88	1	2.24	1.62	1.12	13.69
11.46297422	19	8.5	8-S-2	12.64	4.02	1	1.56	2.81	2.13	1.38	26.24
11.46297627	22	10	10-S-2	16.77	4.49	1.5	1.75	3.39	3.5	1.75	45.86
11.46297823	26	15	15-S-2	17.13	5	1.5	1.75	3.39	3.5	1.75	62.83
11.46298127		25	25-S-2	20.75	5.98	2.01	2.01	4.61	3.68	2.38	141.1
11.46298225		35	35-S-2	20.75	6.5	2.01	2.01	4.61	3.68	2.38	154.32
11.46298323		45	45-S-2	25.24	7.01	2.24	2.5	5	4.02	2.99	235.89