

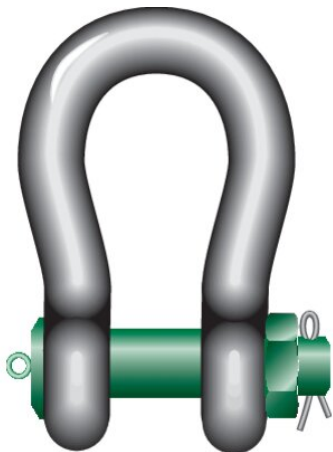

Heavy Duty Bow Shackle BN Van Beest Green Pin® P-6036

Product information



The Green Pin® Heavy Duty Bow Shackle BN is a high load capacity bow shackle with a safety bolt. The Green Pin® Heavy Duty Bow Shackle BN is a good choice for heavy lifting projects and is suitable for both one-leg en multi-leg systems. When rotation of the pin is a risk, this shackle's safety bolt prevents accidental unscrewing. Another important feature of the product is that the Green Pin® Heavy Duty Bow Shackle BN conforms to a wide range of certifications. For example, Heavy Duty Shackles of 150T and higher include a Lloyd's proofload test certificate. The Green Pin® Heavy Duty Bow Shackle BN is available in a range with a working load limit from 120 up to 1500 ton.

Certification on request: 2.1, 2.2, 3.1, MTCa, MTCb, LROS, MPIa, USA [... Read more](#)

Material: Bow and pin alloy steel, quenched and tempered.

Marking: CE-marked

Finish: Shackle bow painted silver, pin painted green

Note: This shackle can also be delivered with fixed nut (an extra AISI 316 securing bolt is drilled through both the nut and shackle pin. This securing bolt is fastened with two sets of Nord-Lock®)

Safety factor: 5:1

Grade: 8



Heavy Duty Bow Shackle BN Van Beest Green Pin® P-6036

Blueprint

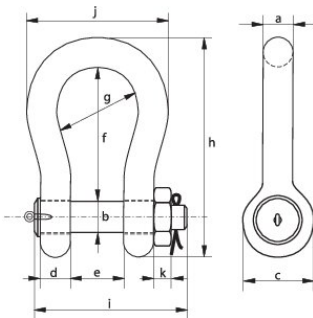

Technical data

Part code	WLL (metric) tonnes	A in	B in	C in	D in	e in	f in	g in	h in	i in	j in	k in	Weight lb
420112000970	120	3.74	3.74	8.19	3.74	5.79	15.75	9.37	25.47	17.83	16.85	1.97	242.51
420115000970	150	4.13	4.25	9.37	4.13	6.65	16.14	10.83	27.09	19.53	19.09	1.97	352.74
420120000970	200	4.72	5.12	10.98	4.72	7.05	20.2	11.42	32.99	22.2	20.87	2.76	518.09
420125000970	250	5.12	5.51	11.77	5.12	8.07	21.81	12.01	35.59	24.17	22.24	2.76	650.36
420130000970	300	5.51	5.91	12.8	5.51	8.07	24.33	12.01	39.21	25.35	23.03	3.15	811.3
420140000970	400	6.69	6.89	14.8	6.46	9.09	26.3	12.8	43.86	27.17	26.18	2.76	1,234.59
420150000970	500	7.09	7.28	15.67	6.46	10.08	28.27	13.78	46.85	28.35	27.95	2.76	1,510.17
420160000970	600	7.87	8.07	17.48	7.44	11.1	28.27	14.76	48.94	31.89	30.51	2.76	1,940.07
420170000970	700	8.27	8.46	17.87	8.03	12.13	28.27	15.75	49.72	34.25	32.28	2.76	2,160.53
420180000970	800	8.27	8.66	18.27	8.03	12.13	28.27	15.75	50	34.25	32.28	2.76	2,425.09
420190000970	900	8.66	9.06	19.09	8.46	12.91	28.27	16.54	51.02	36.22	33.86	2.76	2,821.92
420110000971	1,000	9.45	9.45	20.28	8.46	13.74	28.27	16.54	52.6	37.01	35.43	2.76	3,218.75
420112500971	1,250	10.24	10.63	23.03	9.06	14.53	30.24	17.72	57.32	40.35	38.19	2.76	4,387.2
420115000971	1,500	11.02	11.42	24.61	9.06	14.53	32.2	17.72	61.26	40.35	39.76	2.76	5,291.1