



Foundry Eye Hook Cartec CYX

Product information

Grade 100 eye foundry hooks engineered for heavy-duty lifting applications. Forged from high-strength steel and designed without a latch, these open-throat hooks provide a wide throat opening — making them ideal for fast hook-on and release during material handling operations where bulky or irregular loads are frequent ... [Read more](#)



Marking: CE-marked

Safety factor: 4:1

Grade: 10



Foundry Eye Hook Cartec CYX

Blueprint

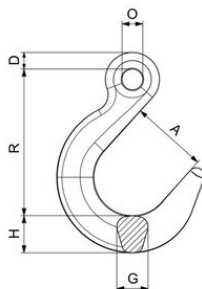

Technical data

Part code	Chain diameter mm	WLL (metric) tonnes	A in	D, in	G, in	H, in	Omm in	Rmm in	Weight lb
402300141870	6	1.4	2.11	0.45	0.87	1.02	1.85	4.04	1.34
402300251870	6-7	2.5	2.44	0.53	0.98	1.14	0.94	5.04	2.03
402300401870	10	4	2.99	0.55	0.91	1.18	1.26	5.91	3.9
402300671870	13	6.7	3.5	0.75	1.5	1.57	1.06	6.81	6.22
402301001870	16	10	4.02	0.94	1.77	1.89	0.59	8.27	11.09
402301601870	20	16	4.49	1.1	2.13	2.36	2.2	10.24	16.76
402301901870	22	19	5	1.26	2.48	2.76	2.17	10.83	27.12
402302651870	26	26.5	5.35	1.38	2.83	3.15	2.44	12.01	39.46
402304001870	32	40	6.02	1.5	3.31	3.74	2.76	12.99	60.19