



## Clevis Foundry Hook Cartec CYFX

### Product information



Clevis foundry hook CYFX designed for grade 100 lifting applications. Features a wide throat opening for easy engagement and a clevis connection for direct attachment to chain slings. Built from high-strength alloy steel to ensure durability and reliability under heavy loads. Ideal for use in foundries and industrial environments where quick, secure handling of molds and components is required. Engineered for demanding lifting operations, offering robust performance and long service life.

... [Read more](#)

**Material:** Alloy steel

**Marking:** CE-marked

**Temperature range:** -40°C up to +200°C

**Finish:** Powder coated

**Safety factor:** 4:1

**Grade:** 10



## Clevis Foundry Hook Cartec CYFX

### Blueprint

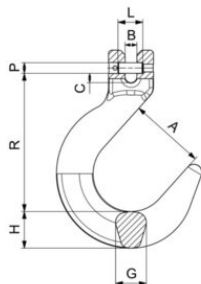

### Technical data

Part code	Chain diameter mm	Chain diameter in	WLL	A in	B in	C in	G, in	H, in	Rmm in	PxL in	Weight lb
402300142290	6	1/4	3,000	2.11	0.33	0.26	0.87	1.02	3.58	0.3	1.54
402300192290	7	9/32	4,300	2.52	0.39	0.45	1.02	1.22	4.74	0.35	2.43
402300252290	8	5/16	5,700	2.52	0.39	0.45	1.02	1.22	4.74	0.39	2.43
402300402290	10	3/8	8,800	2.99	0.51	0.59	1.18	1.34	5.16	0.51	3.75
402300672290	13	1/2	15,000	3.5	0.67	0.69	1.57	1.75	5.83	0.63	7.94
402301002290	16	5/8	22,600	3.98	0.75	0.85	1.77	1.99	7.81	0.83	12.35