



## Eye Clevis Shortening Hook Cartec CDFX

### Product information



Eye clevis shortening hook CDFX designed for grade 100 lifting applications. Features an integrated shortening function that allows precise adjustment of chain length in sling assemblies. The eye connection ensures easy attachment to master links or other components, while the clevis design provides secure chain engagement. Built from high-strength alloy steel for durability and reliability in heavy-duty environments such as construction, industrial rigging, and material handling. [... Read more](#)

**Material:** Alloy steel

**Marking:** CE-marked

**Temperature range:** -40°C up to +200°C without reduction in WLL

**Finish:** Powder coated

**Safety factor:** 4:1

**Grade:** 10



## Eye Clevis Shortening Hook Cartec CDFX

### Blueprint

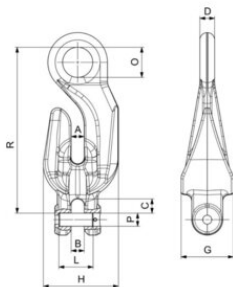

### Technical data

Part code	Chain diameter mm	Chain diameter in	WLL	A in	B in	C in	D, in	G, in	Omm in	Rmm in	H, in	PxL in	Weight lb
402300142360	6	1/4	3,000	0.31	0.3	0.35	0.35	1.14	0.71	3.35	1.46	0.3	0.66
402300192360	7	9/32	4,300	0.37	0.39	0.45	0.47	1.54	0.94	4.82	2.13	0.35	1.48
402300252360	8	5/16	5,700	0.37	0.39	0.43	0.47	1.54	0.94	4.8	2.13	0.39	1.48
402300402360	10	3/8	8,800	0.51	0.47	0.59	0.57	1.97	1.22	6.3	2.76	0.51	2.87
402300672360	13	1/2	15,000	0.63	0.61	0.69	0.71	2.52	1.46	8.03	3.62	0.63	6.61
402301002360	16	5/8	22,600	0.79	0.73	0.85	0.94	3.15	1.89	9.13	4.02	0.83	11.46