



# LAM-É ST-PIERRE

## CUSTOM LIFTING SOLUTIONS GUIDE

Thanks to our engineering, design and fabrication teams, the LAM-É ST-PIERRE GROUP are able to build your custom lifting devices. Whether you're lifting or moving loads or simply require advanced ergonomics we can help. Our mobile service team offers inspection and maintenance services for all your lifting equipment.



[www.lamestpierre.com](http://www.lamestpierre.com)



**LAM-É  
ST-PIERRE**

## CUSTOM LIFTING SOLUTIONS SERVICES

This catalog is to highlight the products and services we can offer to our customers.

Whether you are moving parts, lifting loads or require ergonomic efficiencies, the LAM-É ST-PIERRE GROUP can help you reach your goals.

Our engineering department, technical advisers, fabrication team and our sales force are ready to work with you.

The LAM-É ST-PIERRE GROUP provides design, engineering, and training, making us much more involved than simply distribution.

The LAM-É ST-PIERRE GROUP offers inspections, repairs and testing to certify lifting and securing devices.

As a trusted company, the LAM-É ST-PIERRE GROUP has a knowledgeable and committed work force to provide an unparalleled service.



**LAM-É  
ST-PIERRE**

## OUR PROJECT GALLERY

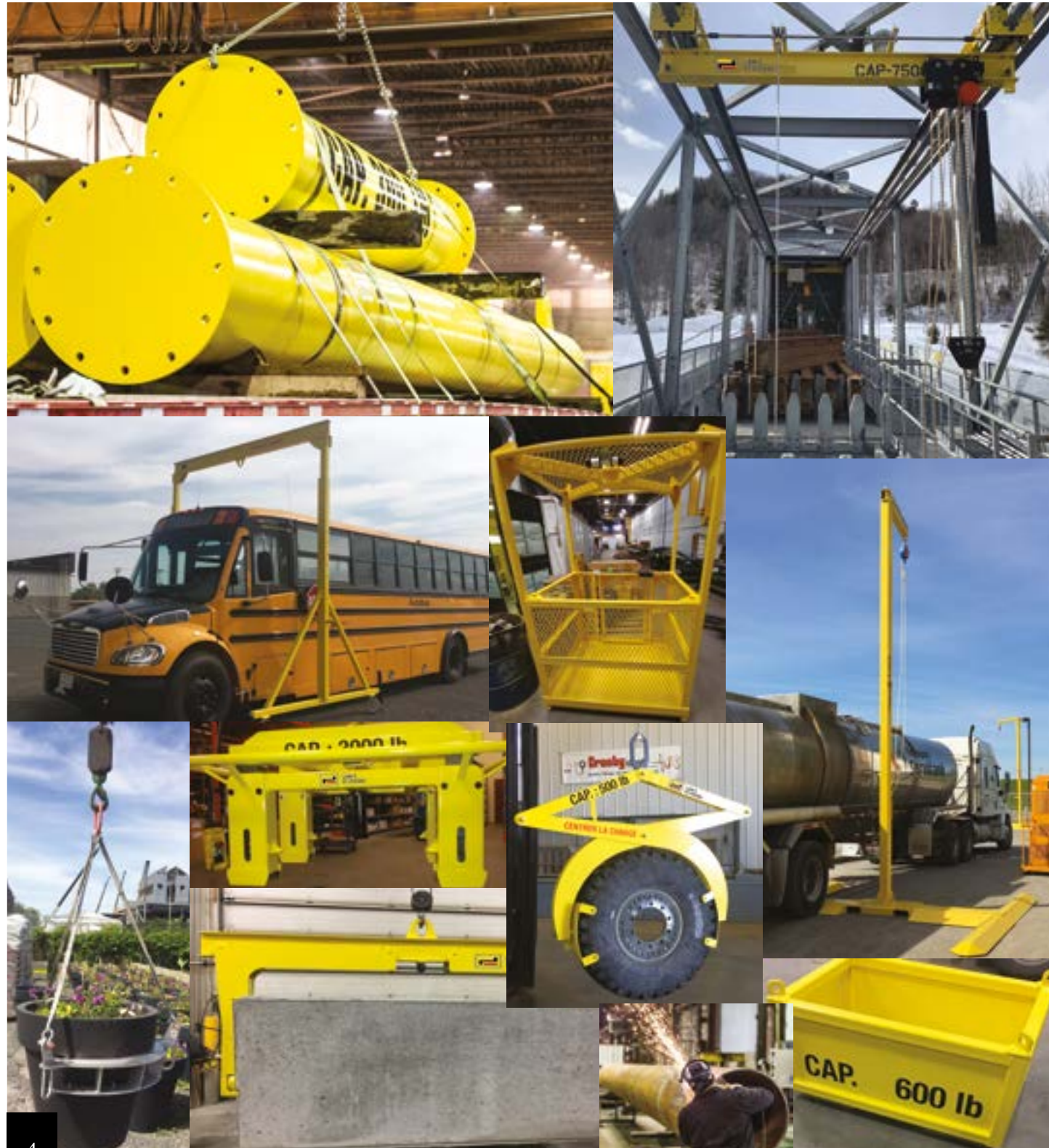

## ROAD SERVICE

The LAM-É ST-PIERRE GROUP offers inspection and maintenance services for your lifting equipment. Our trucks are all equipped for service calls to provide the fastest service possible.

Our inspection report clearly demonstrates what has been inspected. The repair quote tells you the relative cost to obtain a valid certification for use.

## JIB CRANES

Thanks to our wide range of options, the LAM-É ST-PIERRE GROUP offers flexible and inexpensive solutions for moving equipment around your workplace.

From attaching to lifting devices or providing additional equipment, our JIB cranes can fully adapt to your needs.

Installed on a wall or on a column, these JIB cranes make moving loads an easy process. Whatever you need to move or lift, the LAM-É ST-PIERRE GROUP can make it easier, safer and more efficient.

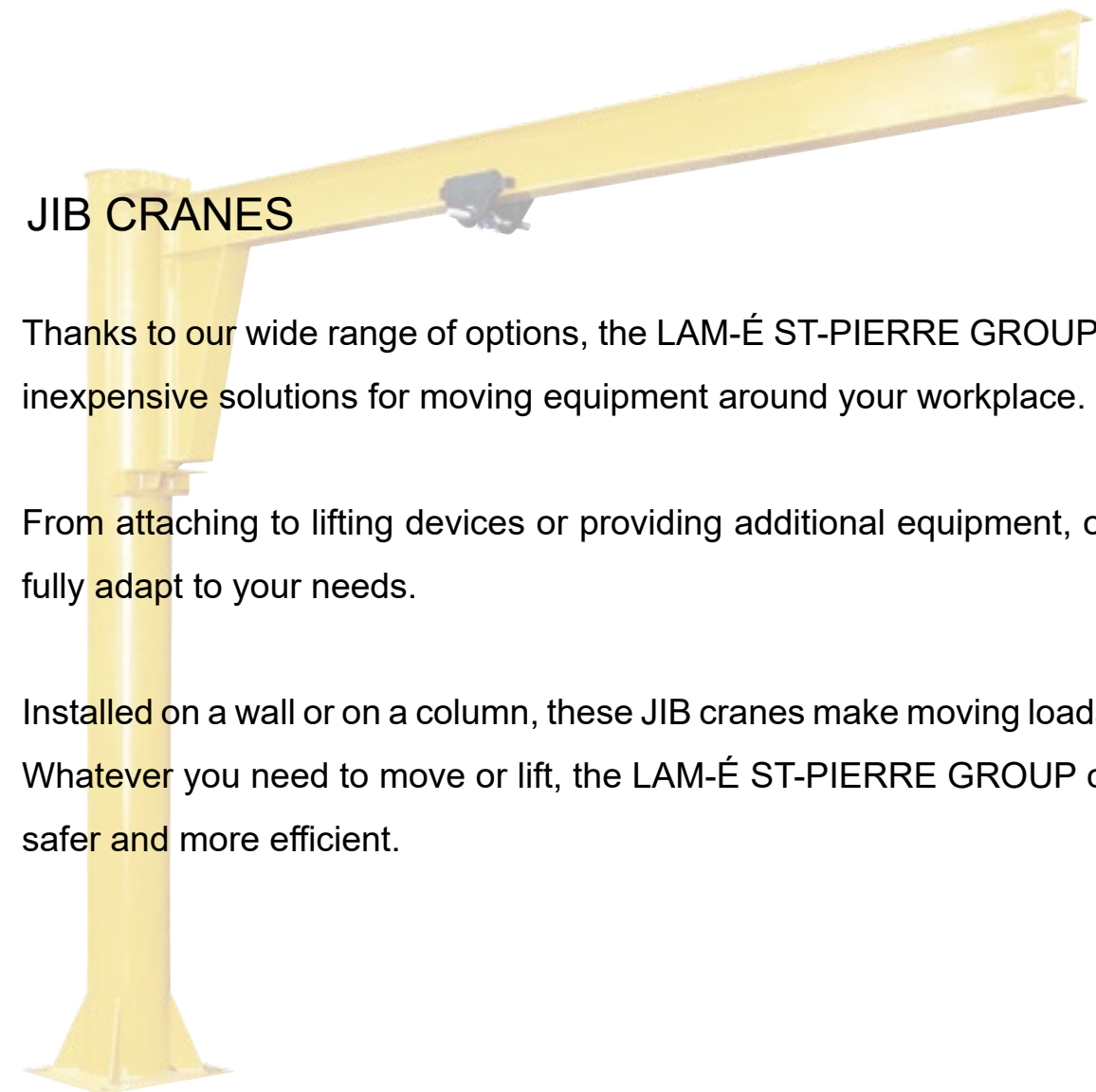

## WALL MOUNT ARTICULATING JIB CRANE

If you have narrow spaces or require specific capacities, this JIB crane will optimize headroom.

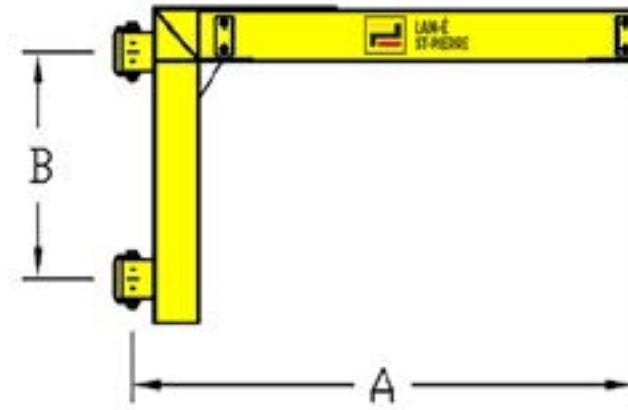

CAPACITY (TON)	MODEL	PART # (FT.)	DIM. A (FT.)	DIM. B (IN.)	FORCE TENSION TOP HINGE (LB) *	WEIGHT (LB) *
1/2	P2-1/2-08	8	8	36	3 500	315
1/2	P2-1/2-10	10	10	36	4 500	350
1/2	P2-1/2-12	12	12	36	5 600	375
1/2	P2-1/2-14	14	14	54	5 000	400
1/2	P2-1/2-16	16	16	66	5 000	750
1/2	P2-1/2-20	20	20	78	4 700	1 100
<hr/>						
1	P2-01-08	8	8	48	4 800	350
1	P2-01-10	10	10	60	5 000	650
1	P2-01-12	12	12	60	6 100	700
1	P2-01-14	14	14	60	7 100	750
1	P2-01-16	16	16	72	7 400	1 000
1	P2-01-20	20	20	72	9 600	1 000
<hr/>						
2	P2-02-08	8	8	48	9 500	600
2	P2-02-10	10	10	48	12 300	650
2	P2-02-12	12	12	48	15 000	750
2	P2-02-14	14	14	60	14 500	1 100
2	P2-02-16	16	16	72	14 300	1 400
2	P2-02-20	20	20	78	17 400	1 900
<hr/>						
3	P2-03-08	8	8	48	14 200	800
3	P2-03-10	10	10	48	18 300	900
3	P2-03-12	12	12	72	15 000	1 100
3	P2-03-14	14	14	72	17 800	1 200
3	P2-03-16	16	16	78	19 300	1 700
3	P2-03-20	20	20	114	17 500	2 700
<hr/>						
5	P2-05-08	8	8	78	15 500	1 300
5	P2-05-10	10	10	78	20 000	1 400
5	P2-05-12	12	12	78	24 500	1 500
5	P2-05-14	14	14	90	25 000	1 800
5	P2-05-16	16	16	114	24 000	2 400
5	P2-05-20	20	20	114	30 000	3 000

\* APPROXIMATE

## WALL MOUNT ARTICULATING JIB CRANE

TECHNICAL FORM TO COMPLETE

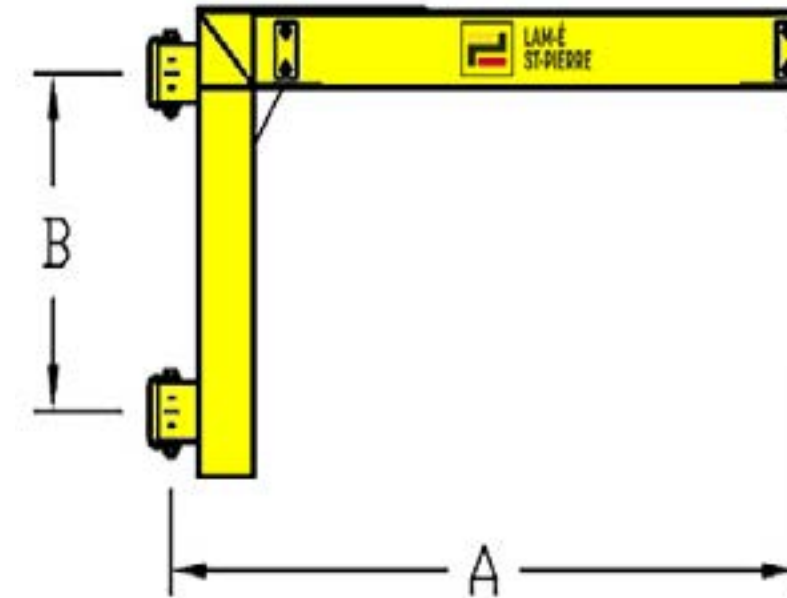

### SPECIFICATIONS REQUESTED

Lifting capacity :

Dimension A :

Dimension B :

### CUSTOMER INFORMATION

Client name :

Address :

Phone :

Email :

## SELF-SUPPORTING JIB WITH STEM

Installation conditions requiring fixing directly to the ground and a structure light will allow you to guide loads precisely and quickly, even in cases large spans.

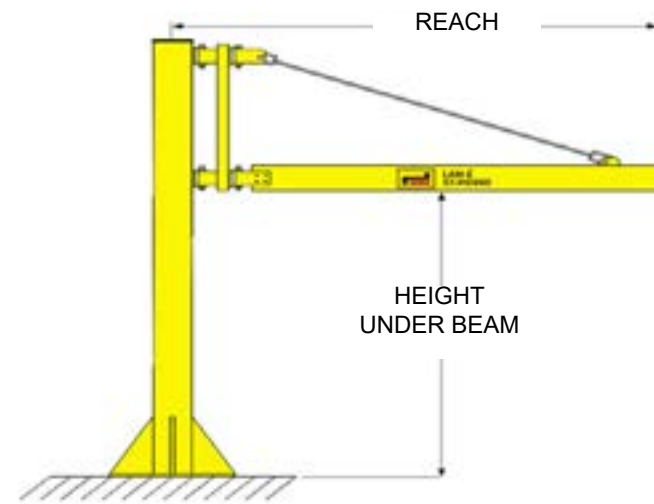

## SELF-SUPPORTING JIB WITH STEM

### TECHNICAL FORM TO COMPLETE

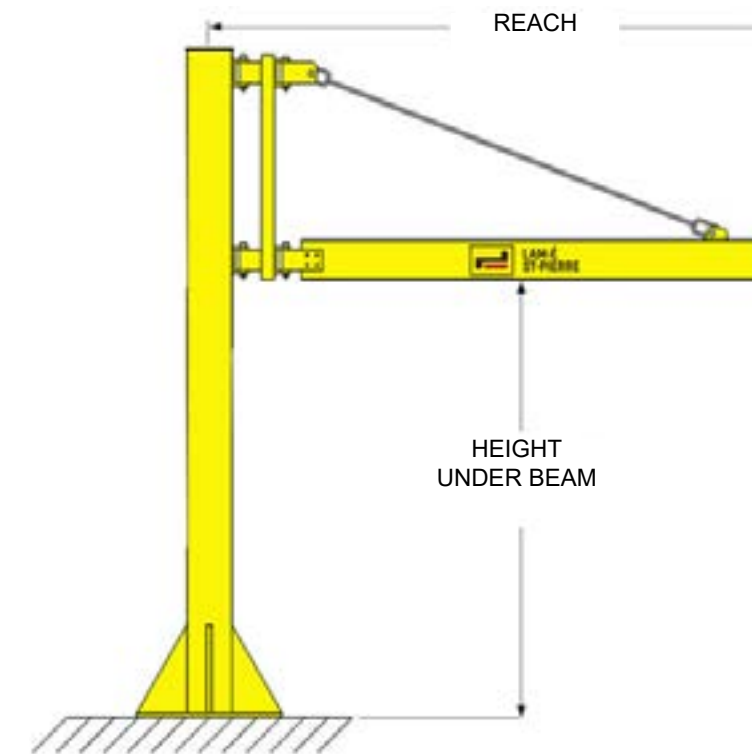

CAPACITY (TON)	HEIGHT UNDER BEAM	PART # 12' REACH	PART # 14' REACH	PART # 16' REACH	PART # 18' REACH	PART # 20' REACH
1/2	10	AP1-051012	AP1-051014	AP1-051016	AP1-051018	AP1-051020
1/2	12	AP1-051212	AP1-051214	AP1-051216	AP1-051218	AP1-051220
1/2	14	AP1-051412	AP1-051414	AP1-051416	AP1-051418	AP1-051420
1/2	16	AP1-051612	AP1-051614	AP1-051616	AP1-051618	AP1-051620
1/2	18	AP1-051812	AP1-051814	AP1-051816	AP1-051818	AP1-051820
1/2	20	AP1-052012	AP1-052014	AP1-052016	AP1-052018	AP1-052020
<b>1</b>						
1	10	AP1-101012	AP1-101014	AP1-101016	AP1-101018	AP1-101020
1	12	AP1-101212	AP1-101214	AP1-101216	AP1-101218	AP1-101220
1	14	AP1-101412	AP1-101414	AP1-101416	AP1-101418	AP1-101420
1	16	AP1-101612	AP1-101614	AP1-101616	AP1-101618	AP1-101620
1	18	AP1-101812	AP1-101814	AP1-101816	AP1-101818	AP1-101820
1	20	AP1-102012	AP1-102014	AP1-102016	AP1-102018	AP1-102020
<b>2</b>						
2	10	AP1-201012	AP1-201014	AP1-201016	AP1-201018	AP1-201020
2	12	AP1-201212	AP1-201214	AP1-201216	AP1-201218	AP1-201220
2	14	AP1-201412	AP1-201414	AP1-201416	AP1-201418	AP1-201420
2	16	AP1-201612	AP1-201614	AP1-201616	AP1-201618	AP1-201620
2	18	AP1-201812	AP1-201814	AP1-201816	AP1-201818	AP1-201820
2	20	AP1-202012	AP1-202014	AP1-202016	AP1-202018	AP1-202020
<b>3</b>						
3	10	AP1-301012	AP1-301014	AP1-301016	AP1-301018	AP1-301020
3	12	AP1-301212	AP1-301214	AP1-301216	AP1-301218	AP1-301220
3	14	AP1-301412	AP1-301414	AP1-301416	AP1-301418	AP1-301420
3	16	AP1-301612	AP1-301614	AP1-301616	AP1-301618	AP1-301620
3	18	AP1-301812	AP1-301814	AP1-301816	AP1-301818	AP1-301820
3	20	AP1-302012	AP1-302014	AP1-302016	AP1-302018	AP1-302020
<b>5</b>						
5	10	AP1-501012	AP1-501014	AP1-501016	AP1-501018	AP1-501020
5	12	AP1-501212	AP1-501214	AP1-501216	AP1-501218	AP1-501220
5	14	AP1-501412	AP1-501414	AP1-501416	AP1-501418	AP1-501420
5	16	AP1-501612	AP1-501614	AP1-501616	AP1-501618	AP1-501620
5	18	AP1-501812	AP1-501814	AP1-501816	AP1-501818	AP1-501820
5	20	AP1-502012	AP1-502014	AP1-502016	AP1-502018	AP1-502020

SPECIFICATIONS REQUESTED	
Lifting capacity :	
Height under boom :	
Scope :	
CUSTOMER INFORMATION	
Client name :	
Address :	
Phone :	
Email :	

## FREE STANDING ARTICULATING JIB CRANE

Floor mount installations will allow you to guide loads precisely and quickly while maximizing headroom.

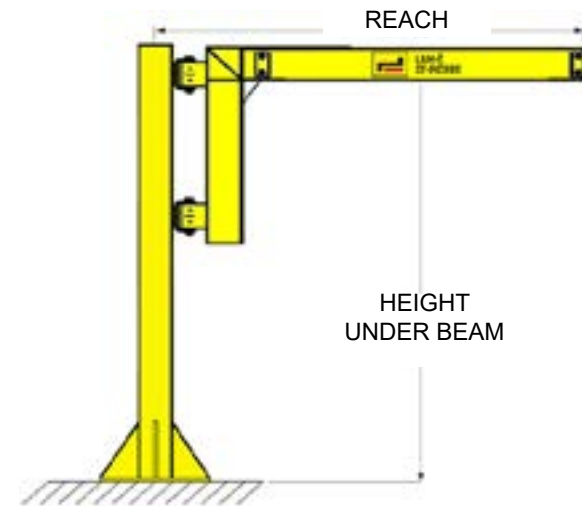

CAPACITY (TON)	HEIGHT UNDER BEAM	PART # 12' REACH	PART # 14' REACH	PART # 16' REACH	PART # 18' REACH	PART # 20' REACH
1/2	10	AP1-051012	AP1-051014	AP1-051016	AP1-051018	AP1-051020
1/2	12	AP1-051212	AP1-051214	AP1-051216	AP1-051218	AP1-051220
1/2	14	AP1-051412	AP1-051414	AP1-051416	AP1-051418	AP1-051420
1/2	16	AP1-051612	AP1-051614	AP1-051616	AP1-051618	AP1-051620
1/2	18	AP1-051812	AP1-051814	AP1-051816	AP1-051818	AP1-051820
1/2	20	AP1-052012	AP1-052014	AP1-052016	AP1-052018	AP1-052020
<b>1 TON</b>						
1	10	AP1-101012	AP1-101014	AP1-101016	AP1-101018	AP1-101020
1	12	AP1-101212	AP1-101214	AP1-101216	AP1-101218	AP1-101220
1	14	AP1-101412	AP1-101414	AP1-101416	AP1-101418	AP1-101420
1	16	AP1-101612	AP1-101614	AP1-101616	AP1-101618	AP1-101620
1	18	AP1-101812	AP1-101814	AP1-101816	AP1-101818	AP1-101820
1	20	AP1-102012	AP1-102014	AP1-102016	AP1-102018	AP1-102020
<b>2 TON</b>						
2	10	AP1-201012	AP1-201014	AP1-201016	AP1-201018	AP1-201020
2	12	AP1-201212	AP1-201214	AP1-201216	AP1-201218	AP1-201220
2	14	AP1-201412	AP1-201414	AP1-201416	AP1-201418	AP1-201420
2	16	AP1-201612	AP1-201614	AP1-201616	AP1-201618	AP1-201620
2	18	AP1-201812	AP1-201814	AP1-201816	AP1-201818	AP1-201820
2	20	AP1-202012	AP1-202014	AP1-202016	AP1-202018	AP1-202020
<b>3 TON</b>						
3	10	AP1-301012	AP1-301014	AP1-301016	AP1-301018	AP1-301020
3	12	AP1-301212	AP1-301214	AP1-301216	AP1-301218	AP1-301220
3	14	AP1-301412	AP1-301414	AP1-301416	AP1-301418	AP1-301420
3	16	AP1-301612	AP1-301614	AP1-301616	AP1-301618	AP1-301620
3	18	AP1-301812	AP1-301814	AP1-301816	AP1-301818	AP1-301820
3	20	AP1-302012	AP1-302014	AP1-302016	AP1-302018	AP1-302020
<b>5 TON</b>						
5	10	AP1-501012	AP1-501014	AP1-501016	AP1-501018	AP1-501020
5	12	AP1-501212	AP1-501214	AP1-501216	AP1-501218	AP1-501220
5	14	AP1-501412	AP1-501414	AP1-501416	AP1-501418	AP1-501420
5	16	AP1-501612	AP1-501614	AP1-501616	AP1-501618	AP1-501620
5	18	AP1-501812	AP1-501814	AP1-501816	AP1-501818	AP1-501820
5	20	AP1-502012	AP1-502014	AP1-502016	AP1-502018	AP1-502020

## FREE STANDING ARTICULATING JIB CRANE

### TECHNICAL FORM TO COMPLETE

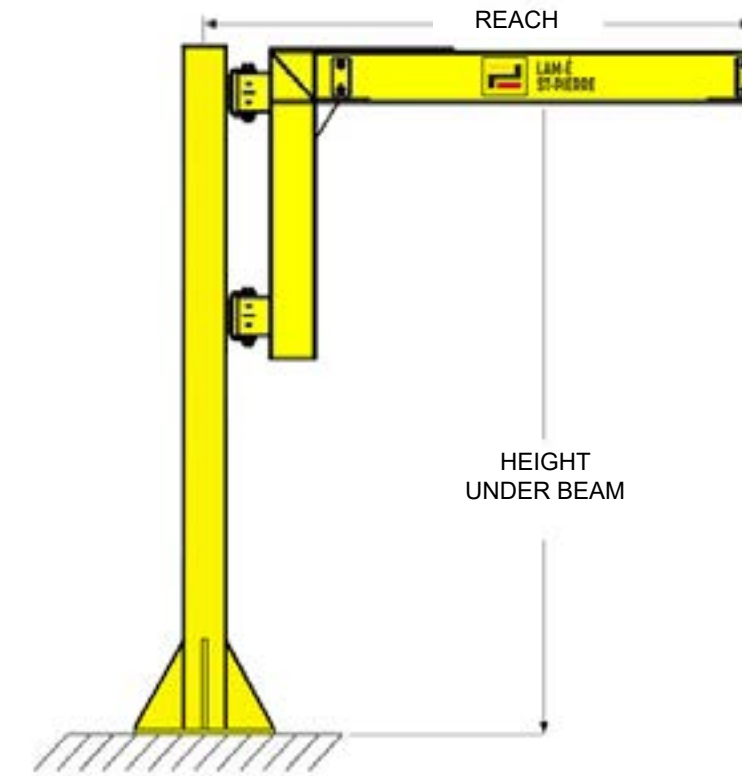

SPECIFICATIONS REQUESTED	
Lifting capacity :	
Height under boom :	
Scope :	
CUSTOMER INFORMATION	
Client name :	
Address :	
Phone :	
Email :	

## LIFTING BEAM - TYPE 2

It is very important to follow proper lifting techniques when handling loads. The LAM-É ST-PIERRE GROUP offer a wide range of standard and custom-made lifting beams adapted to your needs.

- Painted high visibility yellow.
- ALL lifting beams are tested and have the proper certification as required by the industry standards.
- Custom lettering is available.
- Designed and built in accordance with ASME BTH-1 standards and ASME B30.20.

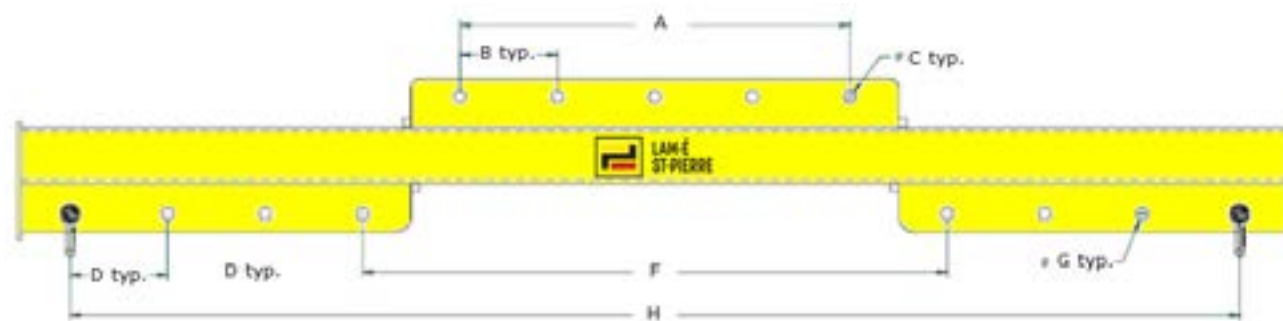

MODEL	CAPACITY (LB.)	A (IN.)	B (IN.)	C (IN.)	D (IN.)	F (IN.)	G (IN.)	H (IN.)
PAL-2-1T-072-10	2000	24	6	0.750	6	36	0.750	72
PAL-2-1T-096-10	2000	24	6	0.750	6	48	0.750	96
PAL-2-1T-120-10	2000	36	6	0.750	6	60	0.750	120
PAL-2-1T-144-10	2000	48	6	0.750	6	72	0.750	144
PAL-2-2T-072-10	4000	24	6	0.750	6	36	0.750	72
PAL-2-2T-096-10	4000	24	6	0.750	6	48	0.750	96
PAL-2-2T-120-10	4000	36	6	0.750	6	60	0.750	120
PAL-2-2T-144-10	4000	48	6	0.750	6	72	0.750	144
PAL-2-3T-072-10	6000	24	6	0.875	6	36	0.750	72
PAL-2-3T-096-10	6000	24	6	0.875	6	48	0.750	96
PAL-2-3T-120-10	6000	36	6	0.875	6	60	0.750	120
PAL-2-3T-144-10	6000	48	6	0.875	6	72	0.750	144
PAL-2-5T-072-10	10 000	24	6	1.125	6	36	1	72
PAL-2-5T-096-10	10 000	24	6	1.125	6	48	1	96
PAL-2-5T-120-10	10 000	36	6	1.125	6	60	1	120
PAL-2-5T-144-10	10 000	48	6	1.125	6	72	1	144

## LIFTING BEAM - TYPE 2

TECHNICAL FORM TO COMPLETE

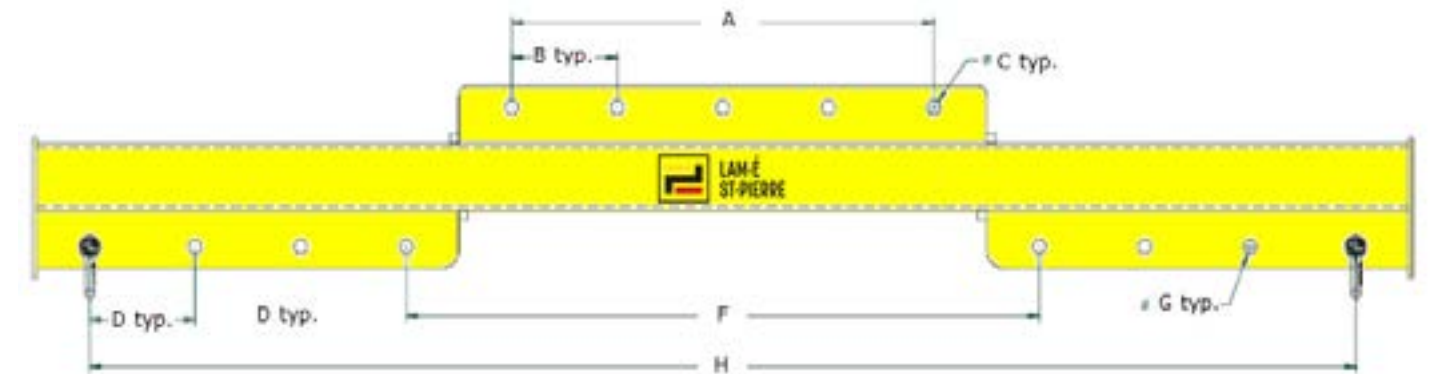

### SPECIFICATIONS REQUESTED

Lifting capacity:	
Dimension A :	
Dimension B :	
Dimension C :	
Dimension D :	
Dimension F :	
Dimension G :	
Dimension H :	

### CUSTOMER INFORMATION

Client name :	
Address :	
Phone :	
Email :	

## LIFTING BEAM - TYPE 3

It is very important to follow proper lifting techniques when handling loads. The LAM-É ST-PIERRE GROUP offer a wide range of standard and custom-made lifting beams adapted to your needs.

- Painted high visibility yellow.
- ALL lifting beams are tested and have the proper certification as required by the industry standards.
- Custom lettering is available.
- Designed and built in accordance with ASME BTH-1 standards and ASME B30.20.

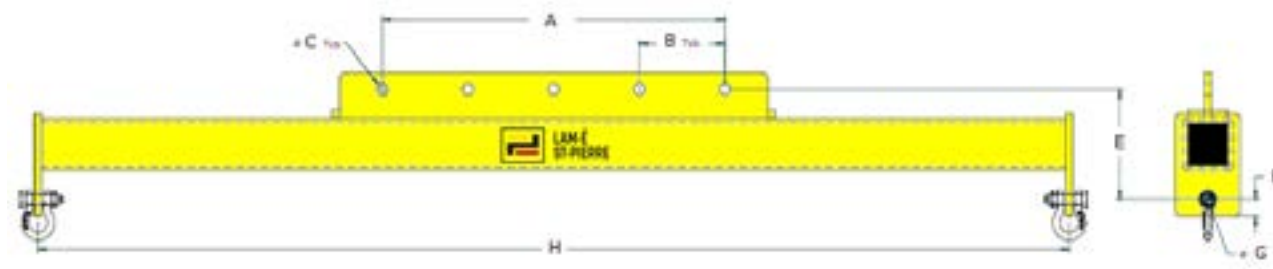

MODEL	CAPACITY (LB.)	A (IN.)	B (IN.)	C (IN.)	E (IN.)	F (IN.)	G (IN.)	H (IN.)
PAL-3-1T-072-10	2000	24	6	0.750	7.250	1.125	0.750	72
PAL-3-1T-096-10	2000	24	6	0.750	7.950	1.125	0.750	96
PAL-3-1T-120-10	2000	36	6	0.750	8.563	1.125	0.750	120
PAL-3-1T-144-10	2000	48	6	0.750	7.323	1.125	0.750	144
<b>4000 LB. CAPACITY</b>								
PAL-3-2T-072-10	4000	24	6	0.750	9.500	1.125	0.750	72
PAL-3-2T-096-10	4000	24	6	0.750	9.625	1.125	0.750	96
PAL-3-2T-120-10	4000	36	6	0.750	9.720	1.125	0.750	120
PAL-3-2T-144-10	4000	48	6	0.750	9.500	1.125	0.750	144
<b>6000 LB. CAPACITY</b>								
PAL-3-3T-072-10	6000	24	6	0.875	9.438	1.125	0.750	72
PAL-3-3T-096-10	6000	24	6	0.875	9.558	1.125	0.750	96
PAL-3-3T-120-10	6000	36	6	0.875	11.658	1.125	0.750	120
PAL-3-3T-144-10	6000	48	6	0.875	13.438	1.125	0.750	144
<b>10 000 LB. CAPACITY</b>								
PAL-3-5T-072-10	10 000	24	6	1.125	11.563	1.125	1	72
PAL-3-5T-096-10	10 000	24	6	1.125	15.682	1.125	1	96
PAL-3-5T-120-10	10 000	36	6	1.125	13.782	1.125	1	120
PAL-3-5T-144-10	10 000	48	6	1.125	13.562	1.125	1	144

## LIFTING BEAM - TYPE 3

### TECHNICAL FORM TO COMPLETE

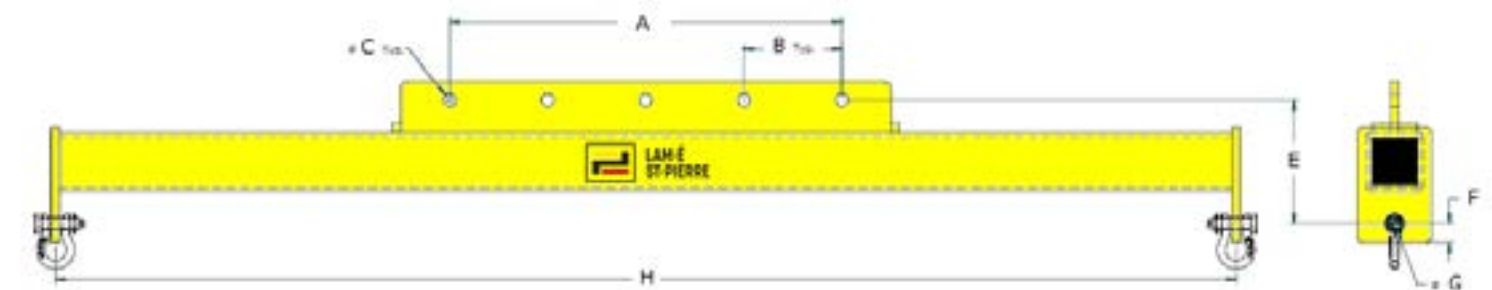

SPECIFICATIONS REQUESTED	
Lifting capacity:	
Dimension A :	
Dimension B :	
Dimension C :	
Dimension E :	
Dimension F :	
Dimension G :	
Dimension H :	
CUSTOMER INFORMATION	
Client name :	
Address :	
Phone :	
Email:	



## LIFTING BEAM - TYPE 4

It is very important to follow proper lifting techniques when handling loads. The LAM-É ST-PIERRE GROUP offer a wide range of standard and custom-made lifting beams adapted to your needs.

- Painted high visibility yellow.
- ALL lifting beams are tested and have the proper certification as required by the industry standards.
- Custom lettering is available.
- Designed and built in accordance with ASME BTH-1 standards and ASME B30.20.

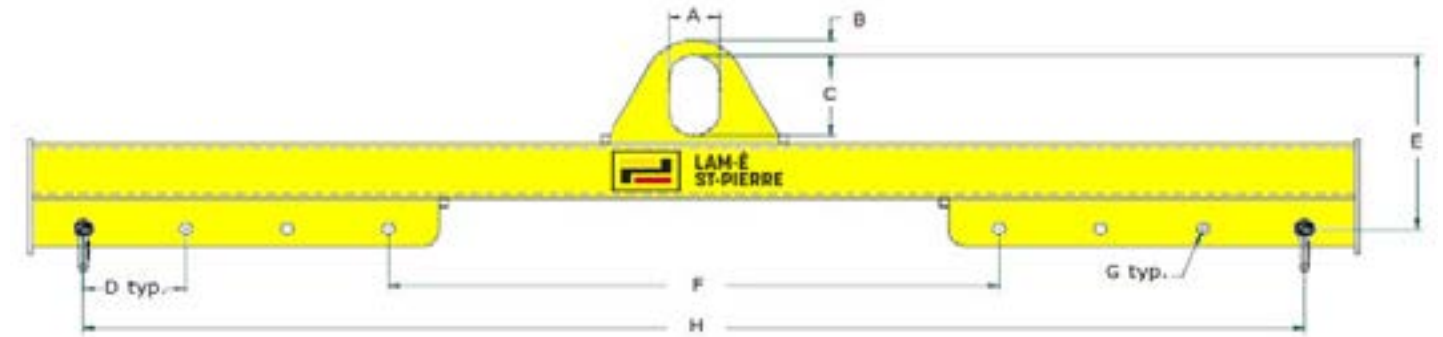
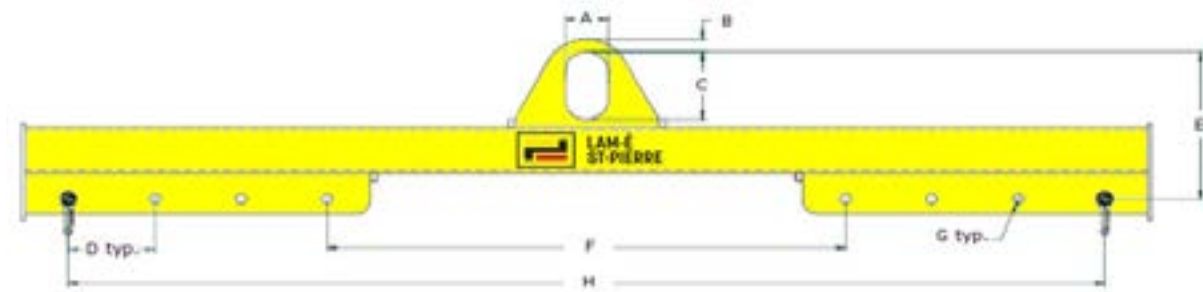

MODEL	CAPACITY (LB.)	A (IN.)	B (IN.)	C (IN.)	D (IN.)	E (IN.)	F (IN.)	G (IN.)	H (IN.)
PAL-4-1T-072-10	2000	3	1	5	6	10.875	36	0.750	72
PAL-4-1T-096-10	2000	3	1	5	6	11.375	48	0.750	96
PAL-4-1T-120-10	2000	3	1	5	6	11.375	60	0.750	120
PAL-4-1T-144-10	2000	3	1	5	6	11.375	72	0.750	144
<hr/>									
PAL-4-2T-072-10	4000	3	1.250	5	6	13.525	36	0.750	72
PAL-4-2T-096-10	4000	3	1.250	5	6	13.655	48	0.750	96
PAL-4-2T-120-10	4000	3	1.250	5	6	13.615	60	0.750	120
PAL-4-2T-144-10	4000	3	1.250	5	6	13.615	72	0.750	144
<hr/>									
PAL-4-3T-072-10	6000	3	1.5	5	6	13.655	36	0.750	72
PAL-4-3T-096-10	6000	3	1.5	5	6	13.615	48	0.750	96
PAL-4-3T-120-10	6000	3	1.5	5	6	15.735	60	0.750	120
PAL-4-3T-144-10	6000	3	1.5	5	6	17.615	72	0.750	144
<hr/>									
PAL-4-5T-072-10	10 000	4	2	7	6	17.860	36	1	72
PAL-4-5T-096-10	10 000	4	2	7	6	21.740	48	1	96
PAL-4-5T-120-10	10 000	4	2	7	6	20.000	60	1	120
PAL-4-5T-144-10	10 000	4	2	7	6	19.920	72	1	144

## LIFTING BEAM - TYPE 4

### TECHNICAL FORM TO COMPLETE

SPECIFICATIONS REQUESTED	
Lifting capacity:	
Dimension A :	
Dimension B :	
Dimension C :	
Dimension D :	
Dimension F :	
Dimension G :	
Dimension H :	
CUSTOMER INFORMATION	
Client name :	
Address :	
Phone :	
Email :	

## LIFTING BEAM - TYPE 5

It is very important to follow certain rules when handling loads. The group LAM-É ST-PIERRE offers a range of standard or tailor-made spreaders adapted to your needs, allowing you to simplify the handling of your loads.

- Painted high visibility yellow.
- ALL lifting beams are tested and have the proper certification as required by the industry standards.
- Custom lettering is available.
- Designed and built in accordance with ASME BTH-1 standards and ASME B30.20.

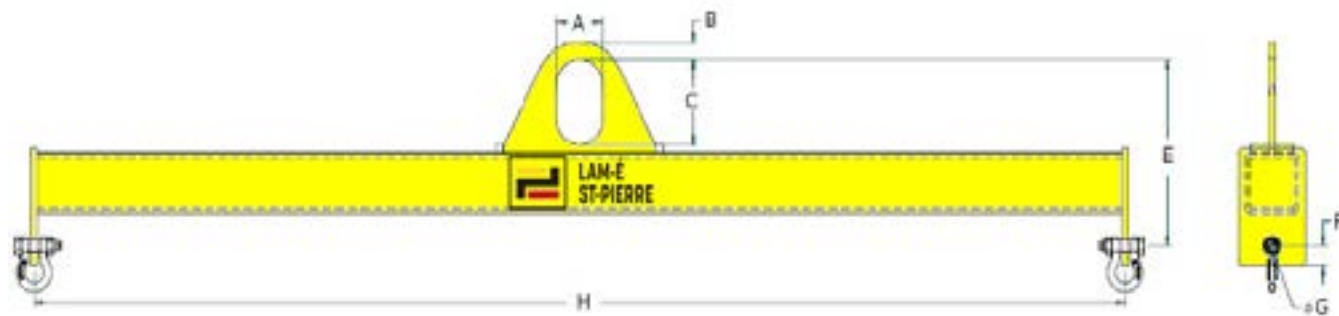

MODEL	CAPACITY (LB.)	A (IN.)	B (IN.)	C (IN.)	E (IN.)	F (IN.)	G (IN.)	H (IN.)
PAL-5-1T-072-10	2000	3	1	5	10.875	1.125	0.750	72
PAL-5-1T-096-10	2000	3	1	5	10.875	1.125	0.750	96
PAL-5-1T-120-10	2000	3	1	5	10.875	1.125	0.750	120
PAL-5-1T-144-10	2000	3	1	5	10.875	1.125	0.750	144
<b>2T</b>								
PAL-5-2T-072-10	4000	3	1.250	5	13.375	1.125	0.750	72
PAL-5-2T-096-10	4000	3	1.250	5	13.375	1.125	0.750	96
PAL-5-2T-120-10	4000	3	1.250	5	13.375	1.125	0.750	120
PAL-5-2T-144-10	4000	3	1.250	5	13.375	1.125	0.750	144
<b>3T</b>								
PAL-5-3T-072-10	6000	3	1.5	5	13.375	1.125	0.750	72
PAL-5-3T-096-10	6000	3	1.5	5	13.375	1.125	0.750	96
PAL-5-3T-120-10	6000	3	1.5	5	13.375	1.125	0.750	120
PAL-5-3T-144-10	6000	3	1.5	5	17.375	1.125	0.750	144
<b>5T</b>								
PAL-5-5T-072-10	10 000	4	2	7	17.625	1.125	1	72
PAL-5-5T-096-10	10 000	4	2	7	21.625	1.125	1	96
PAL-5-5T-120-10	10 000	4	2	7	19.625	1.125	1	120
PAL-5-5T-144-10	10 000	4	2	7	19.625	1.125	1	144

## LIFTING BEAM - TYPE 5

TECHNICAL FORM TO COMPLETE

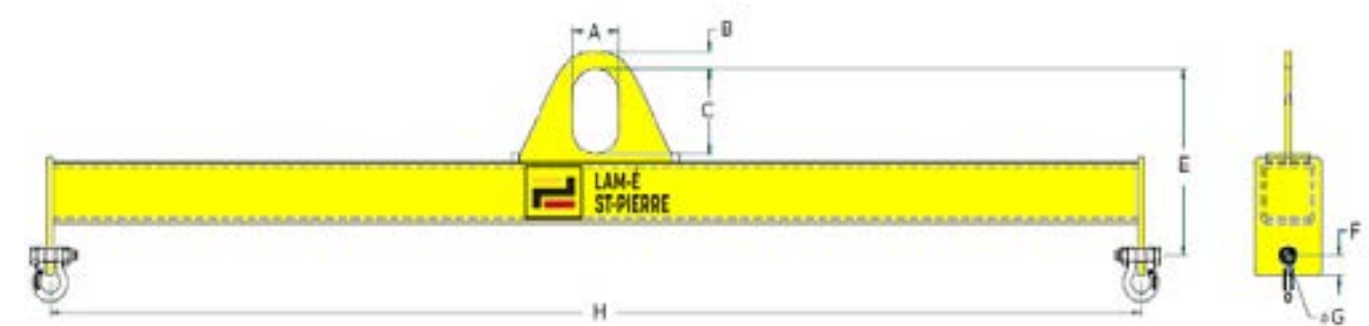

SPECIFICATIONS REQUESTED	
Lifting capacity:	
Dimension A :	
Dimension B :	
Dimension C :	
Dimension E :	
Dimension F :	
Dimension G :	
Dimension H :	
CUSTOMER INFORMATION	
Client name :	
Address :	
Phone :	
Email:	

## PALLET PULLER

### Product Features

- Used for pulling hard to reach pallets on flat surfaces from a truck or a loading dock.
- Painted orange to increase visibility.
- Single action scissors.
- Robust steel design.
- Not designed for lifting.
- 3/8 grade 70 chain.



MODEL	OPENING THE JAWE (IN.)		LENGTH OFCHAIN (IN.)	CAPACITY (KG.)	WEIGHT (LB.)
	Min.	Max.			
PALLETPULMPP1-37F	1.00	4.00	24	500	12.75

## TRAILLER SPOTTER

### Product Features

- Easy attachment, no special tools required.
- Painted orange to increase visibility.
- Robust steel design.
- Not designed for lifting.
- 3/8 grade 70 chain

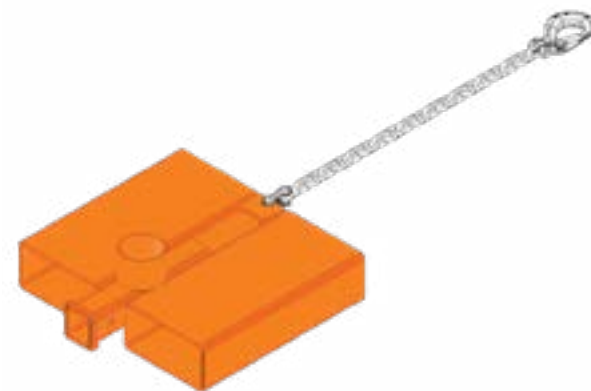

MODEL	DESCRIPTION	CAPACITY (KG.)	WEIGHT (LB.)
SPTR8-37F	"TRAILER SPOTTER", MODEL SPTR. 1-7/8" A 2-5/16"	2000	64.45

## PALLET LIFTER

### Product Features

Available in two versions: fixed and adjustable. Manufactured to customer specifications.

- Transforms the crane into a forklift.
- Adjustable forks to manage various pallet sizes.
- Custom lettering available.
- Designed and built in accordance with ASME BTH-1 standards and ASME B30.20.

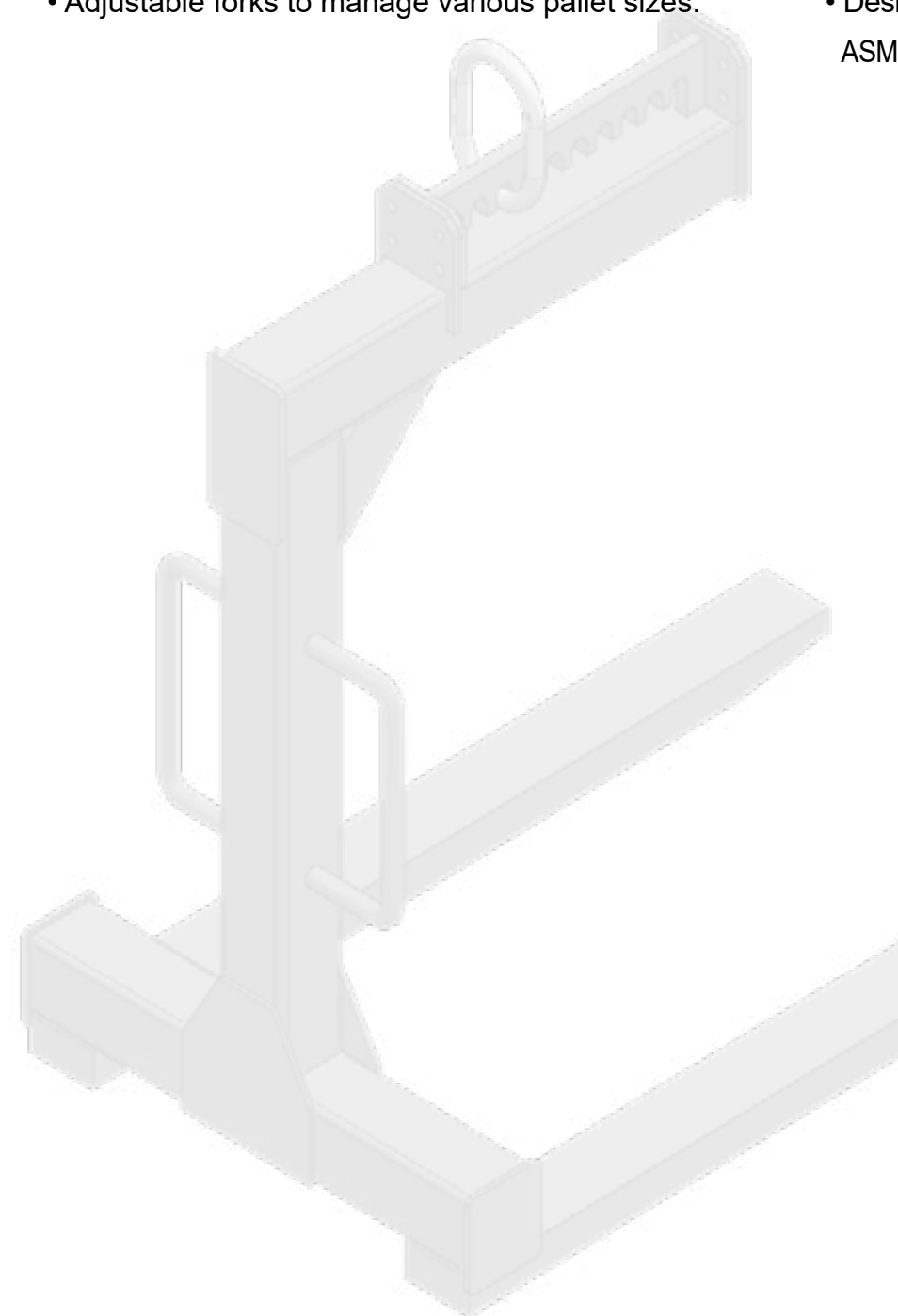

Contact one of  
our advisers for  
an evaluation of  
your project

Montreal T. 1 800 361-4019

Quebec T. 1 800 652-9759

Saguenay T. 1 866 696-9759

## FORKLIFT SINGLE FORK DEVICE

### Product Features

- Easy attachment, no special tools required.
- Painted orange to increase visibility.
- Retaining chain to attach to the forklift.
- Robust steel design.
- Not designed for lifting.
- 3/8 grade 70 chain.

SECURITY CHAIN / HOOK



MODEL	DESCRIPTION	CAPACITY (KG)	WEIGHT (LBS.)
52146-37F	SINGLE FORK HOOK 5-2-1 / 4-6 (INCLUDING SHACKLE AND SAFETY CHAIN)	2250	24.10

## FORKLIFT DOUBLE FORK DEVICE

### Product Features

- Easy attachment, no special tools required.
- Painted orange to increase visibility.
- Retaining chain to attach to the forklift.
- Robust steel design.
- Not designed for lifting.
- 3/8 grade 70 chain.



MODEL	DESCRIPTION	CAPACITY (KG)	WEIGHT (LB.)
10624-37F	24" BEAM FOR FIXED STYLE (INCLUDING SHACKLE AND SAFETY CHAIN)	4500	35.93

## FORK EXTENSIONS

- Painted orange to increase visibility.
- Easy installation on existing forks.
- Adapts to standard fork width and thickness.

Fork extensions 6" wide, 72" long (sold in pairs).  
(You must have a minimum fork length of 48").

MODEL	CAPACITY (KG.)	WEIGHT (LB.)
RFE672-37F	1000 KG / PAIR	60 lb./ unit



## CUSTOM TELESCOPIC BOOM FOR LIFT TRUCK

Telescopic boom for forklift PB-30, can also be used as a lifting beam.

- Designed and built in accordance with ASME BTH-1 standards and ASME B30.20.
- Painted in orange color to increase visibility.
- “t-pin” style lock.



MODEL	CAPACITY (KG.)	WEIGHT (LB.)
FORKLIFTBOOMP30-37F	1200	376.25

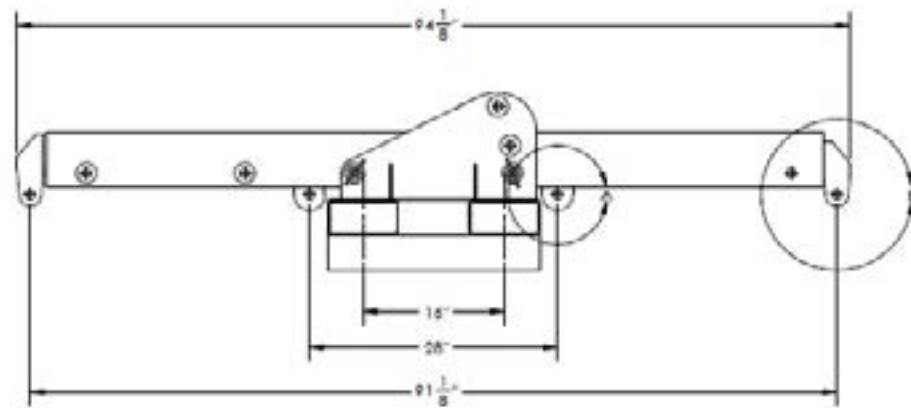

LANDING MODE

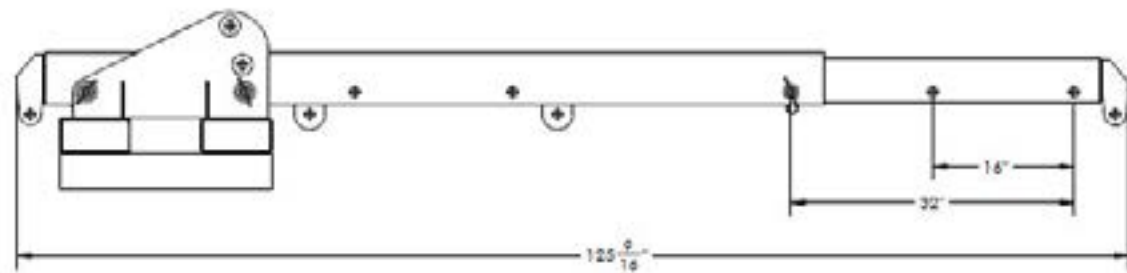
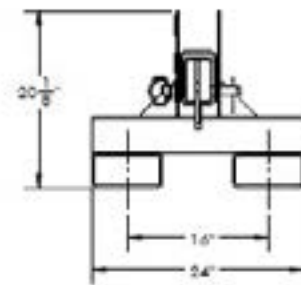

MAXIMUM OPENING

## STANDARD TELESCOPIC BOOM FOR LIFT TRUCK

Telescopic boom for forklift PB-30, can also be used as a lifting beam.

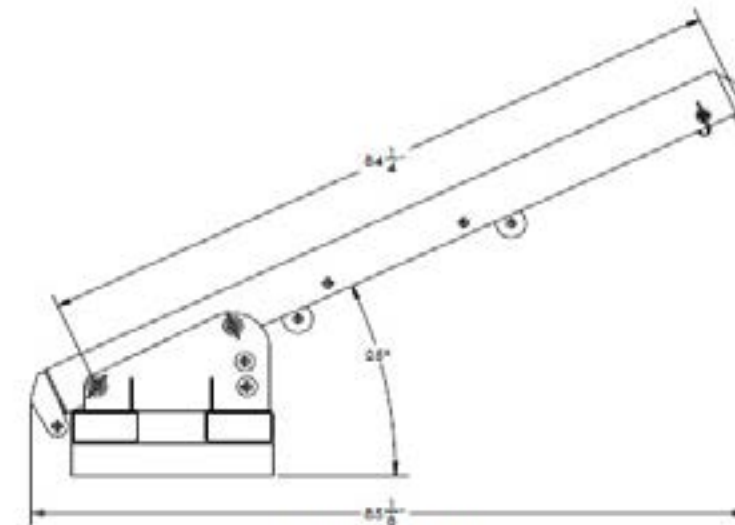

UP ARROW MODEL

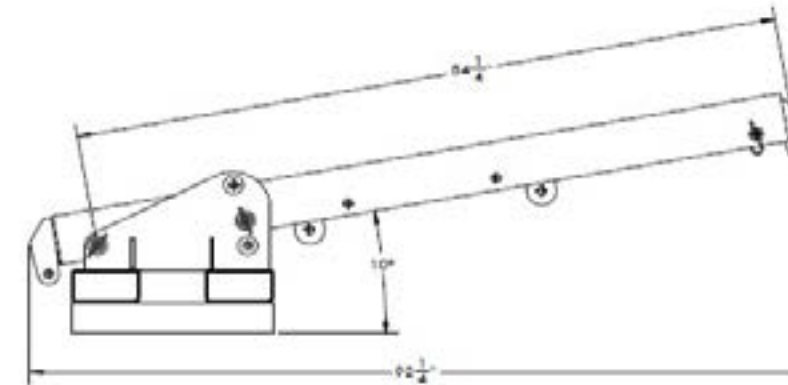

CENTER ARROW MODEL

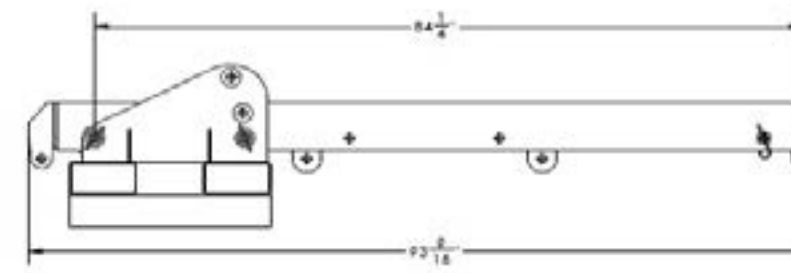

DOWN ARROW MODEL

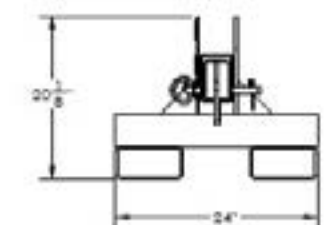
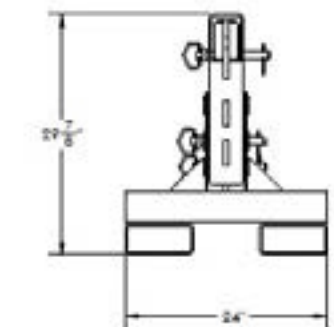
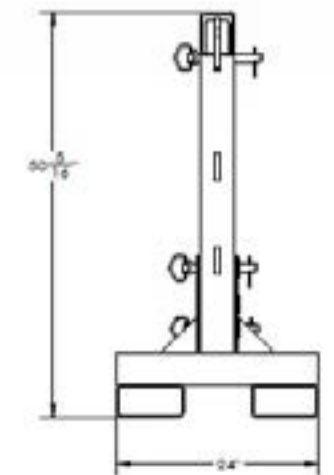

## GANTRY CRANES

Whether fixed, on wheels or motorized, gantry cranes manufactured by the LAM-É ST-PIERRE GROUP are custom-made according to your specifications.

## CUSTOM BRIDGE CRANES

The LAM-É ST-PIERRE GROUP bridge cranes provide a solution for handling simple loads. The different construction combinations provide tailored solutions for your requirements. The LAM-É ST-PIERRE GROUP offers several types of overhead cranes, top running, underhung, single beam, double girder to name a few.

## CUSTOM CLAMPING DEVICES

A multitude of applications require the use of special clamps. The LAM-É ST-PIERRE GROUP manufactures custom clamping devices tailored to the customers' needs.



## “J” and “S” HOOKS

The LAM-É ST-PIERRE GROUP offers a wide range of “J” and “S” type hooks, in different styles, capacities and sizes. We manufacture these custom hooks according to your needs.



### PROJECT EVALUATION

PROJECT N° :  
CUSTOMER :  
SUBJECT :

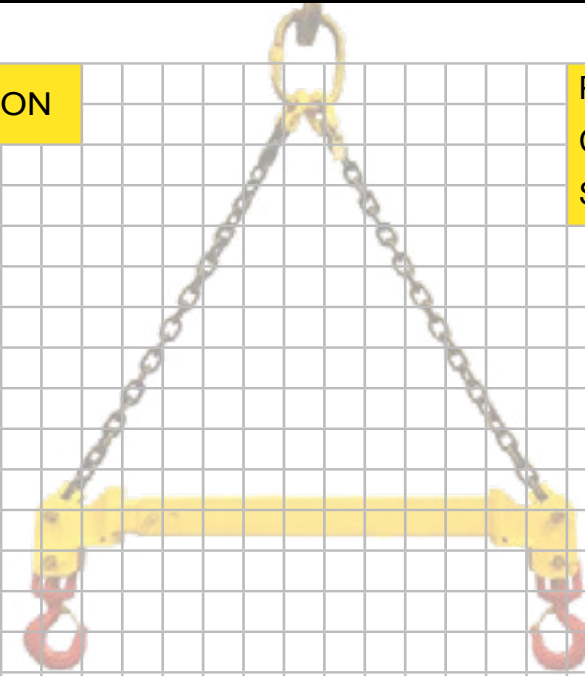

Date :

Name :



# LAM-É ST-PIERRE



## PRODUCT SPECIALISTS IN LIFTING, SECUREMENT AND SAFETY!

Recognized leader in lifting, securing and safety equipment since 1951.



**Montreal**  
7690, rue Jarry Est  
Anjou QC H1J 2M3  
T 514 354-4219 / 1 800 361-4019  
F 514 354-5059

**Montreal**  
9065, Henri-Bourassa Est  
Montréal QC H1E 1P4  
T 514 354-4219 / 1 800 361-4019  
F 514 354-5059

**Quebec**  
1050, boul. Charest Ouest  
Québec QC G1N 0A3  
T 418 652-9759 / 1 800 652-9759  
F 418 653-5744

**Saguenay**  
1002, rue de la Rupert  
Chicoutimi QC G7K 0A1  
T 418 696-9759 / 1 866 696-9759  
F 418 696-9752